

# ROUGH COUNTRY

## SUSPENSION SYSTEMS®

921520030

### FORD 2021 Bronco Aluminum Rails

Thank you for choosing Rough Country for all your vehicle needs.

Please read instructions before beginning installation. Check the kit hardware against the kit contents shown below. Be sure you have all needed parts and know where they go.

If question exist, please call us @1-800-222-7023. We will be happy to answer any questions concerning this product.

Check all fasteners for proper torque. Check to ensure for adequate clearance between all components.

Periodically check all hardware for tightness.

#### KIT CONTENTS:

- Side Rail x2
- Front End Caps x2
- Rear End Caps x2
- Front (F) Brackets x2
- Middle/Rear Brackets x4
- Steps x4

#### TOOLS NEEDED:

- 13mm Wrench or Socket
- 17mm Wrench or Socket

#### HARDWARE INCLUDED:

- 8mm x 10mm Button Head Bolts x12
- 8mm Nuts x12
- 8mm x 25mm Bolts x48
- 8mm Lock Nuts x48
- 8mm Oversized Flat Washers x12
- 10mm x 25mm Bolts x6
- 10mm Flat Washers x6
- 10mm Lock Washers x6



#### Torque Specs:

Size	Grade 5	Grade 8	Size	Class 8.8	Class 10.9
5/16"	15 ft/lbs	20ft/lbs	6MM	5ft/lbs	9ft/lbs
3/8"	30 ft/lbs	35ft/lbs	8MM	18ft/lbs	23ft/lbs
7/16"	45 ft/lbs	60ft/lbs	10MM	32ft/lbs	45ft/lbs
1/2"	65 ft/lbs	90ft/lbs	12MM	55ft/lbs	75ft/lbs
9/16"	95 ft/lbs	130ft/lbs	14MM	85ft/lbs	120ft/lbs
5/8"	135ft/lbs	175ft/lbs	16MM	130ft/lbs	165ft/lbs
3/4"	185ft/lbs	280ft/lbs	18MM	170ft/lbs	240ft/lbs



## INSTALLATION INSTRUCTIONS

1. Locations of installing each part for the passengers side starting at the (A) bracket, center to the right. **See Photo 1.**

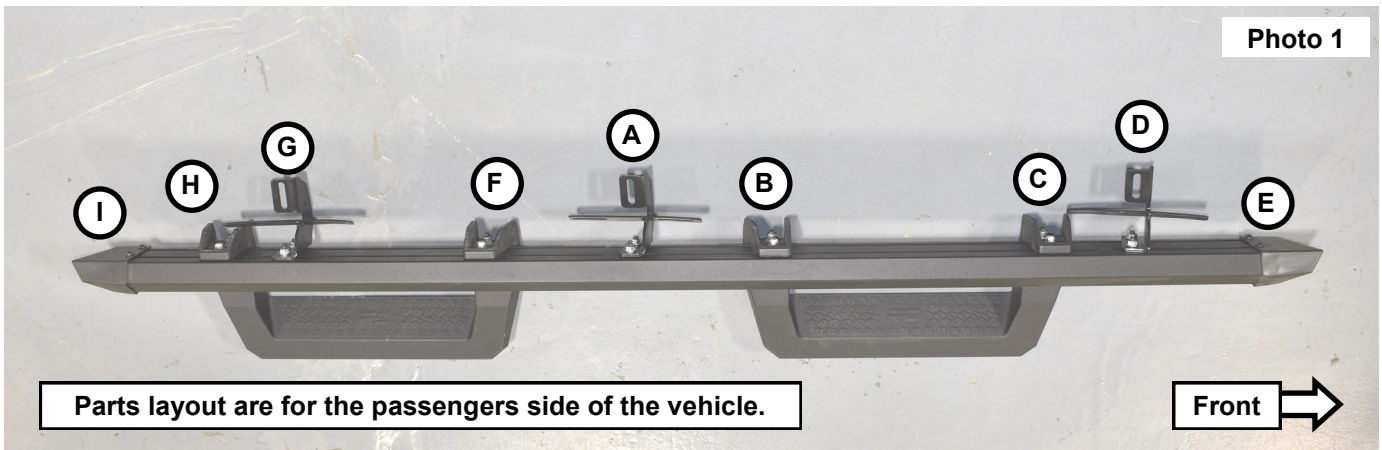

2. Install (2) of the supplied bolts into the rail and center to the rail. **See Photo 2.**
3. Install the center bracket (A) onto the bolts and secure using (2) of the supplied flange nuts. **See Photo 3. Do not tighten at this time.**

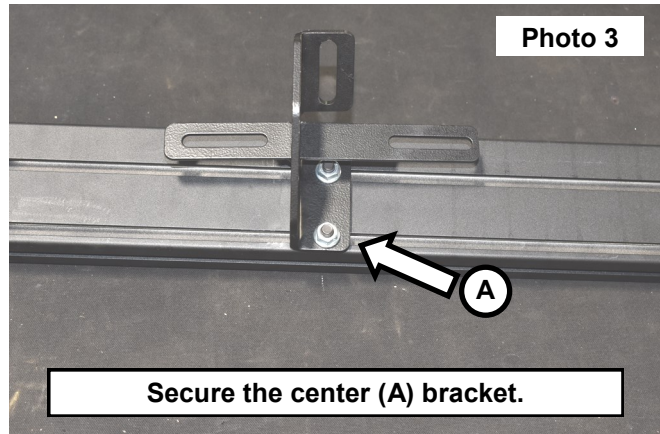
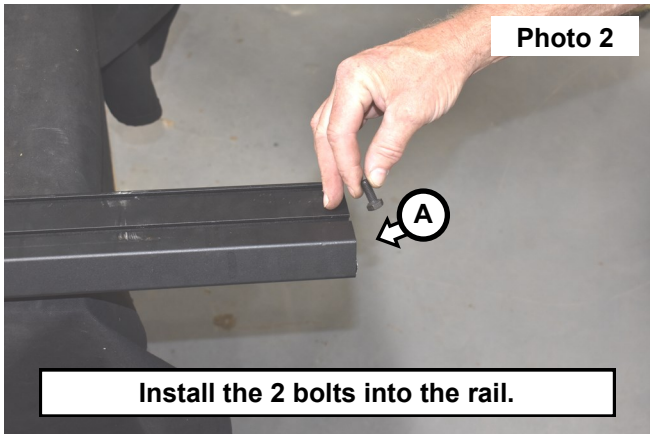

4. Install (3) of the supplied 8mm bolts into each of the front flange of the step (B) and (C). Then thread (3) of the supplied 8mm flange nuts onto each bolt to keep them into the step during installation. Turning the nut flush with the end of the bolt is all that's needed. **See Photo 4 and 5.**

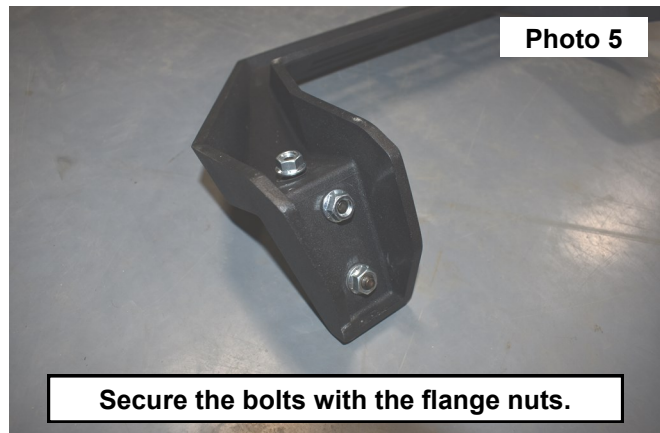
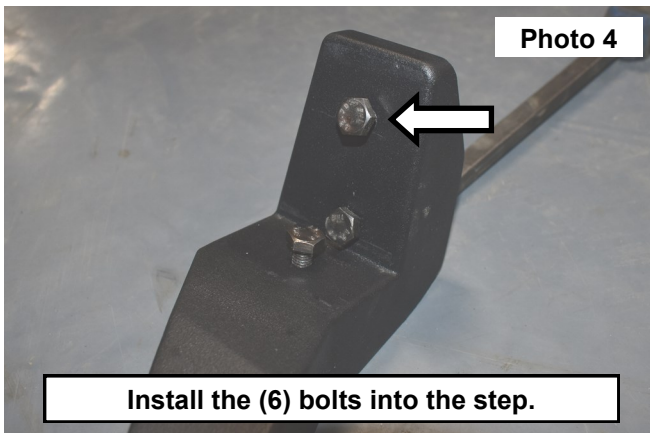

- Installing the front step, insert the hex of the (3) 8mm bolts (B) into the track of the step rail. Slide the step over and install the step mount (C) into the track. **See Photo 6.**
- Slide the step over beside the (A) bracket for installation of the remaining hardware and brackets. **See Photo 7.**

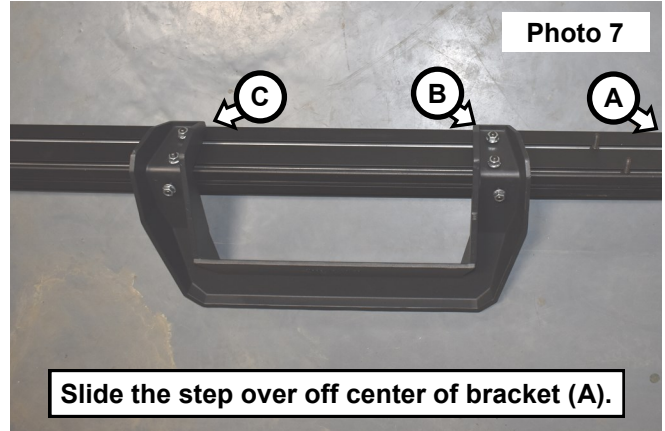
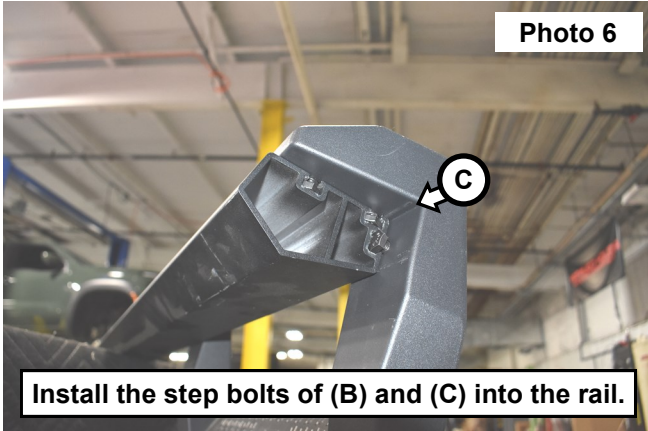

- Install the (2) 8mm bolts into the rail. Install bracket (D) onto the rail and secure using (2) of the flange nuts. **See Photo 8. Do not tighten at this time.**
- Install (3) 8mm nuts into the end of the rail. Location (E). **See Photo 9.**

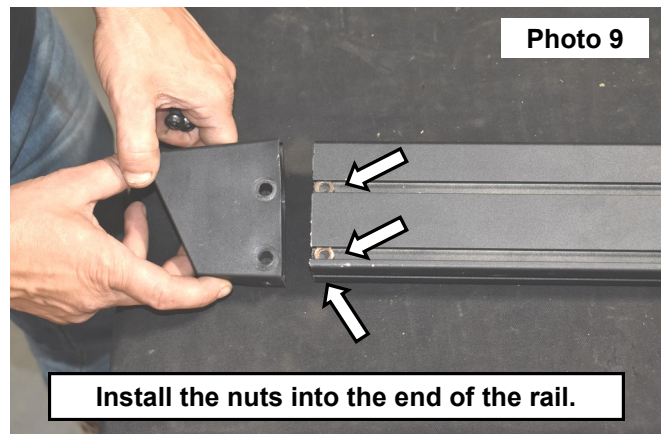
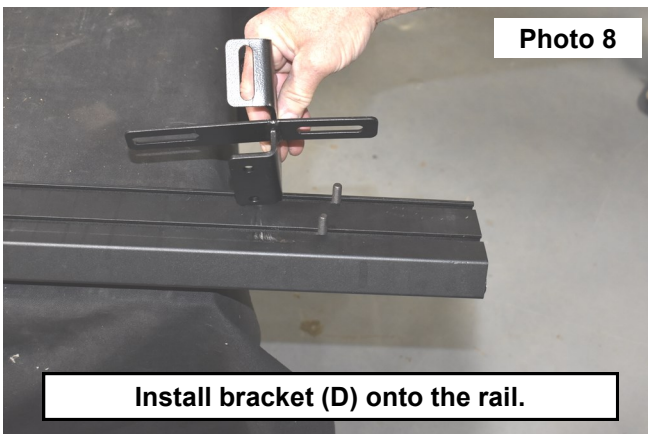

- Install the (3) 8mm nuts into the rail. Then place the end cap (E) over the nuts and secure using (3) of the supplied 8mm button head bolt. Tighten using a 5mm allen wrench. **See Photo 10.**
- Install (3) of the supplied 8mm bolts into each hole of the front flange of the rear step (F) and (H). Then thread (3) of the supplied 8mm flange nuts onto each bolt to keep them into the step during installation. Turning the nut flush with the end of the bolt is all that's needed. **See Photo 11.**

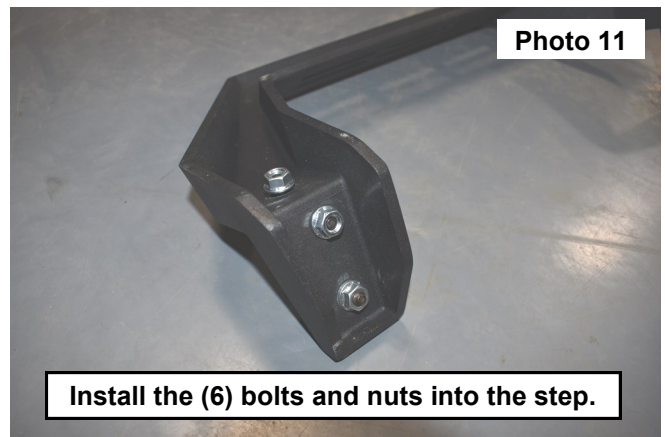
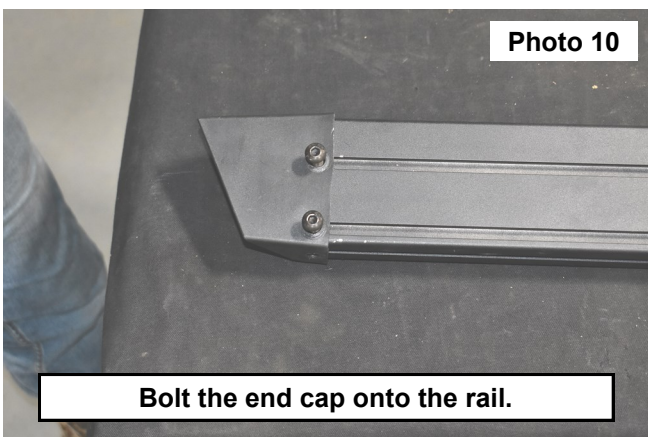

11. Install the hex of the (3) 8mm bolts (F) into the track of the step rail. **See Photo 12.**
12. Slide the step over and install (2) 8mm bolts into the double track of the step rail for mount (G). **See Photo 13.**

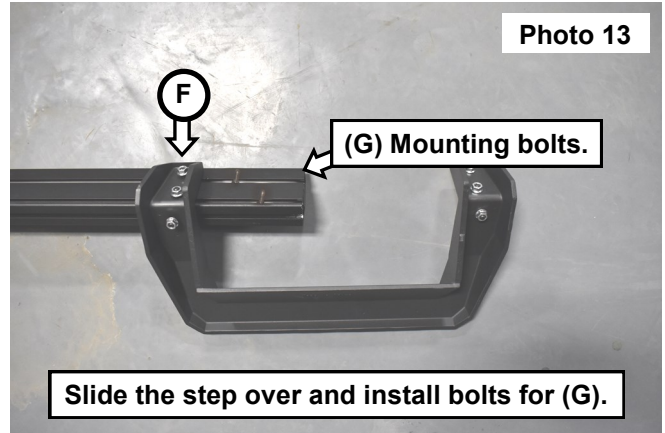
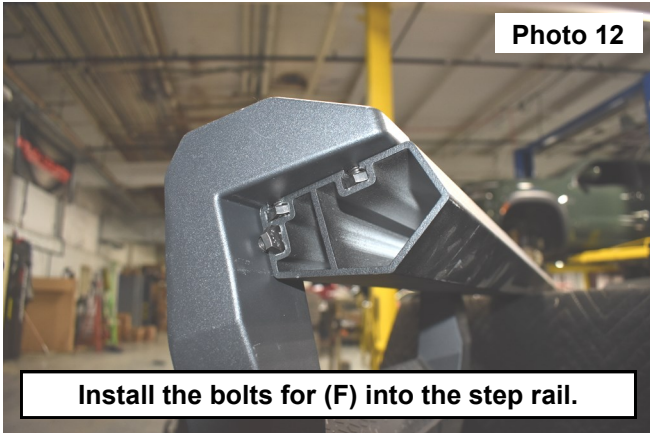

13. Finish installing the step by installing the hex of the (3) 8mm bolts of mount (H) into the track. **See Photo 14.**
14. Slide the step over beside bracket (A) for installation of the remaining hardware.
15. Install the (G) bracket onto the step and secure using (2) 8mm Flange nuts. **See Photo 15.**

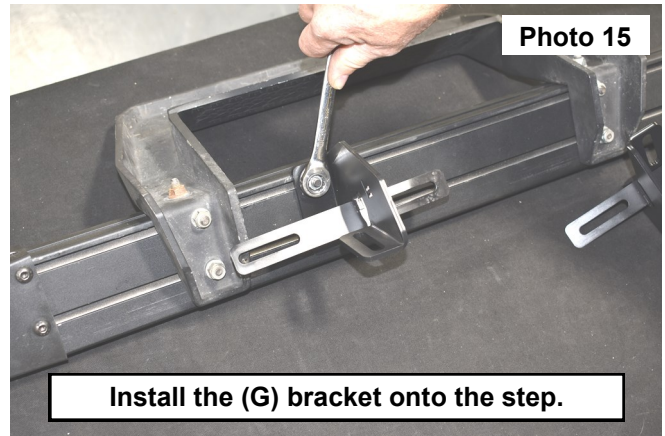
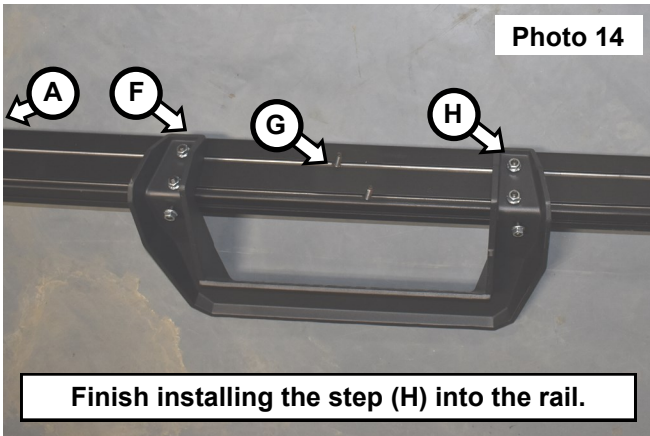

16. Install (3) 8mm nuts into the end of the rail. Location (I) secure the end cap using the supplied 8mm button head bolts. Tighten using a 5mm allen wrench. **See Photo 16.**
17. Install the step onto the vehicle.
18. Mount the step brackets to the pinch weld using (2) 8mm bolts, (2) 8mm washers and (2) 8mm Flange nuts. **See Photo 17.**

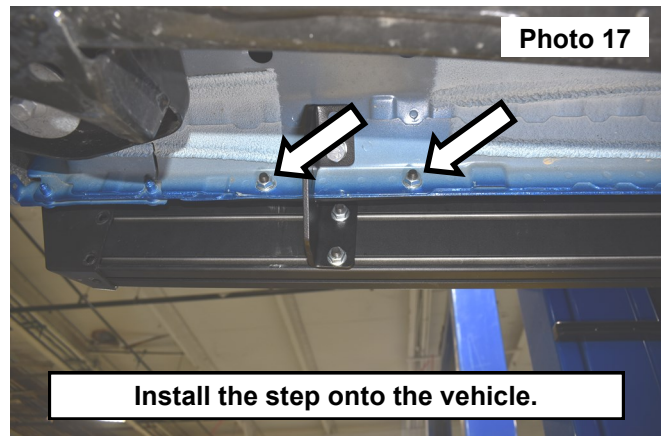
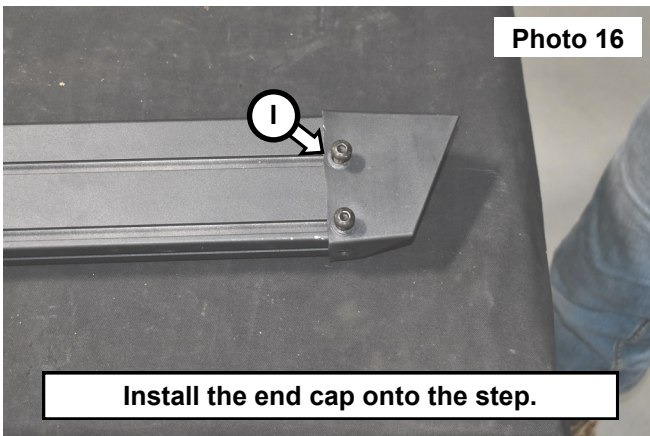

19. Secure the cab mount using (1) 10mm bolt, (1) 10mm lock washer and (1) 10mm Washer. **See Photo 18.**

20. At this time center the step rail between the front and rear fenders. **See Photo 19.**

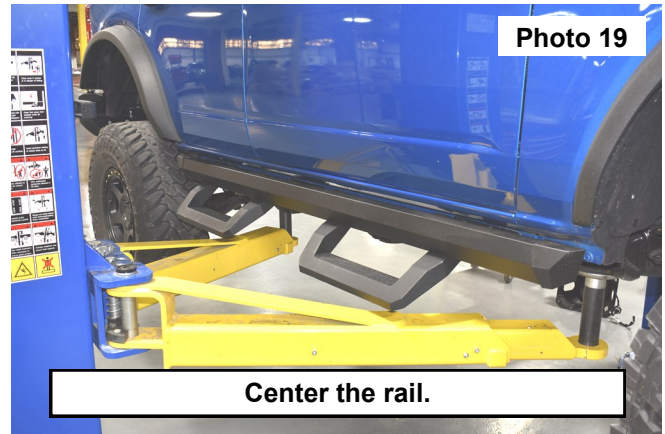
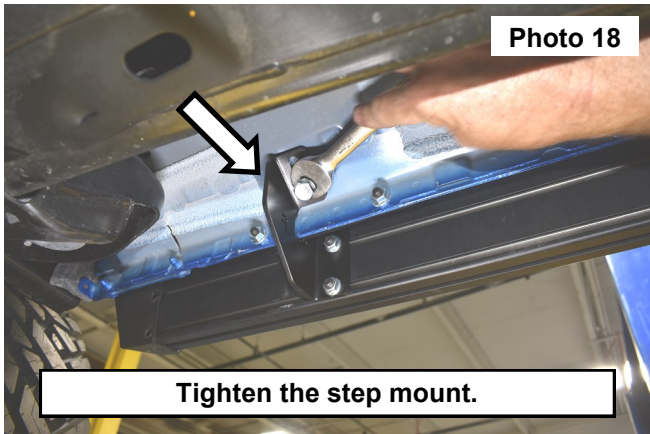

21. Tighten the (3) step mounts to the rail hardware using a 13mm wrench. **See Photo 20.**

22. Position the front and rear steps into the desired location. Record this measurement for the opposite side of the vehicle. **See Photo 21.**

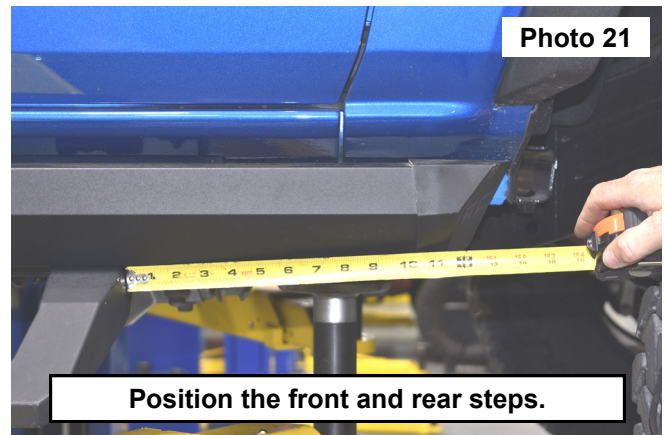

23. Tighten the (6) bolts in the step using a 13mm wrench. **See Photo 22.**

24. Repeat the step installation on the driver side of the vehicle.

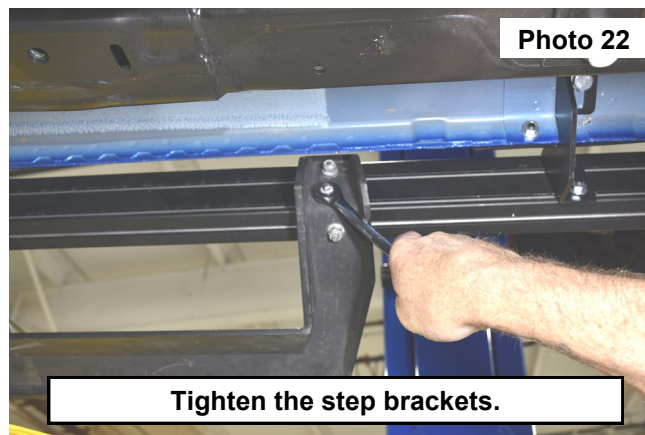

By purchasing any item sold by Rough Country, LLC, the buyer expressly warrants that he/she is in compliance with all applicable, State, and Local laws and regulations regarding the purchase, ownership, and use of the item. It shall be the buyers responsibility to comply with all Federal, State and Local laws governing the sales of any items listed, illustrated or sold. The buyer expressly agrees to indemnify and hold harmless Rough Country, LLC for all claims resulting directly or indirectly from the purchase, ownership, or use of the items.



